

## Watergate construction Markkleeberger/Störmthaler sea

C&E · Consulting und  
Engineering GmbH



09117 Chemnitz • Jagdschänkenstraße 52  
Tel.: +49 (0) 371 881 22 39 • Fax: +49 (0) 371 881 45 89  
E-mail: [info@cue-chemnitz.de](mailto:info@cue-chemnitz.de)  
Internet: [www.cue-chemnitz.de](http://www.cue-chemnitz.de)

**Project Objective:** Technical Assistance for water connection Markkleeberger/Störmthaler sea

**Location:** Markkleeberg

**Client:** Lausitz and Central-German Mining Administration Company „LMBV mbH“

**Beneficiary:** Lausitz and Central-German Mining Administration Company „LMBV mbH“

**Year:** since 2008



### Initial Situation:

The results of the detailed design of the building and equipment technical solutions for the boat transfer to overcome the 4.80 m high level of lake water level using a chamber lock and an additional slipway at the north location under special consideration of over-run water overflow from the Störmthaler sea (regulation construction) including the necessary offshore terminals and one footbridge. The objectives of these measures were water touristy use as well as increase of reuse standards in the brown coal areas.

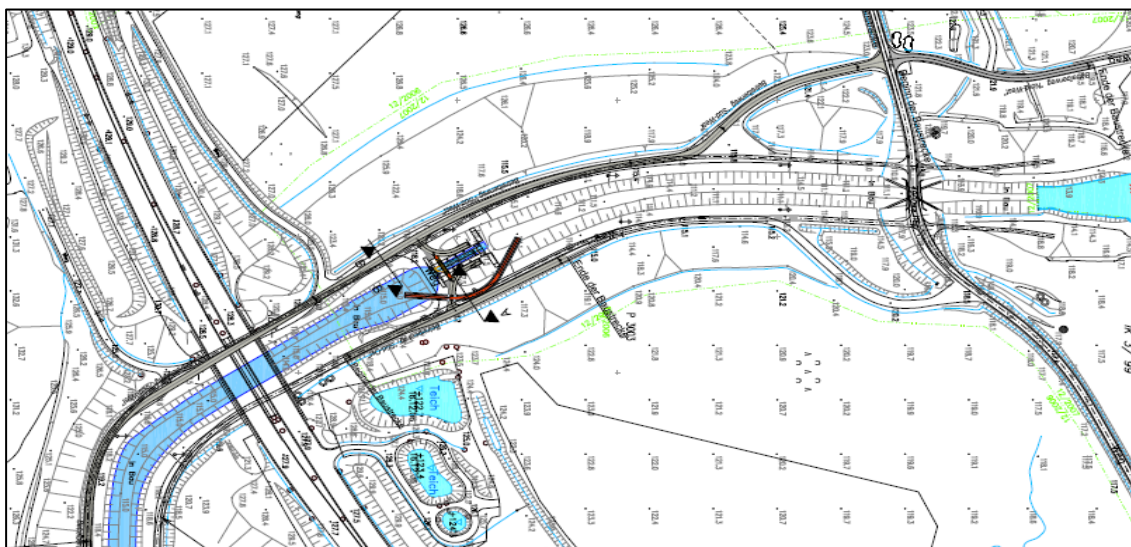

## Watergate construction Markkleeberger/Störmthaler sea

C&E · Consulting und  
Engineering GmbH



09117 Chemnitz • Jagdschänkenstraße 52  
Tel.: +49 (0) 371 881 22 39 • Fax: +49 (0) 371 881 45 89  
E-mail: [info@cue-chemnitz.de](mailto:info@cue-chemnitz.de)  
Internet: [www.cue-chemnitz.de](http://www.cue-chemnitz.de)

**Work Phases:** work phases 5 to 9 acc. to Fee Structure for Architects and Engineers as well as site supervision

### Services Provided:

#### Planning services

- Engineering work: sluice constructions with administration building, free spaces and footway bridge
- Water touristy facilities: slipways, offshore terminals and und landing stage
- Traffic facilities, road connections in the sluice area

#### Planning of structural framework

- Watergate construction
- Footway bridge
- Landing stages in head and tail water

#### Steel construction for hydraulic engineering/electro-magnetic compatibility<sup>1</sup>

- Water civil engineered equipment: lock gate, piping and valve for sluice operation and spillway
- Electro-technics and process measuring and control technology: energy supply and illumination, measurement and control engineering, technical equipment for the increased corrosion prevention of steel parts

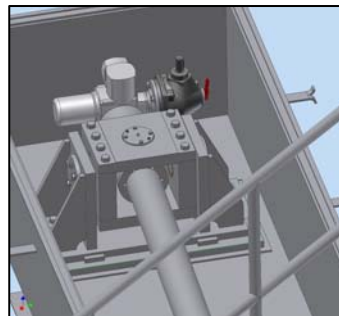
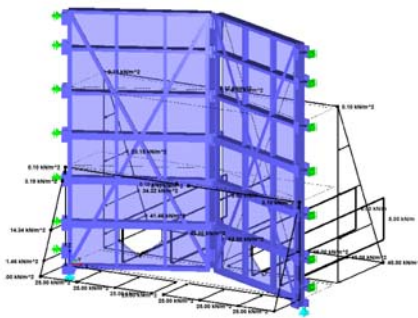

#### Planning of sea connection

- Planning of canal down to the Störmthaler sea with the overall length of approx. 400 m
- Technical implementation of the canal and sea bulging
- Setting up of long-term stable slope inclination
- Shoreline stabilisation of the canal and sea bulging

<sup>1</sup> Planning of steel construction for hydraulic engineering/electro-magnetic compatibility<sup>1</sup> is carried out by consulting company Döhler (Neustrelitz)